

BLINDS CATALOGUE



EXTERNAL BLINDS

Highly effective sun protection
+ long life of blinds = pleasant interior climate



Z-90 external blinds

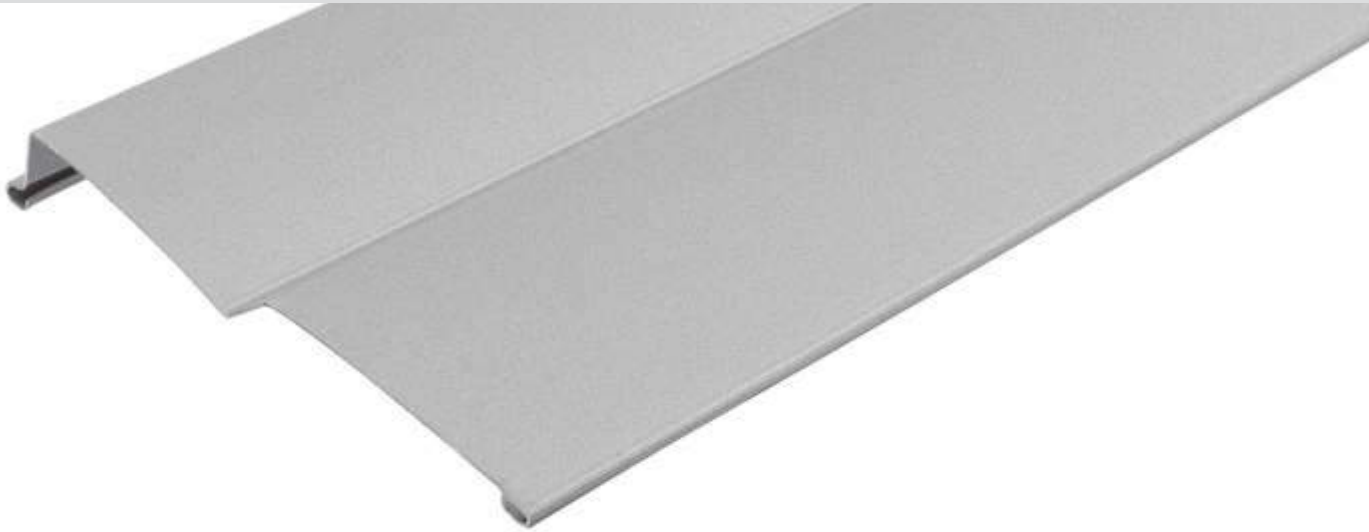

Z-90 EXTERNAL BLINDS

Z-type external blinds are technically the best types of external blinds.

Z-90 external blinds have a very modern Z-shape, allowing for complete closing of slats. They are functional and effective, and their functionalistic, angular shape fits very well into modern exteriors. These blinds have excellent interior shading results, and with their rolled seal they also efficiently eliminate noise. Technological excellence combined with angular, minimalist design – that is the Z-90 blind.

MAIN ADVANTAGES

- » **fully sealable design**
- » **excellent shading and darkening results**
- » **noise-free operation and noise-eliminating seal**
- » **very strong slats**
- » **optional operation (crank handle/motor)**



Metal ladder connection
made of stainless steel significantly increases lifetime of external blinds.



Upper profile
in two finishes (extruded aluminium or galvanized steel) is opened downwards:

- » allows free access to all components,
- » prevents sticking of dirt and other obstacles,
- » allows easy adjusting, eg. of gearbox.



Slat hooks
Slats are fixed to ladder by re-openable hooks, which allow easy exchange of any slat (repair on spot).



Elliptical metal pin
placed 1 piece on each slat alternating left or right reduces external noise and wind noise to minimum.



Quality lift tape
In our production we use lift tape 8 mm of Swiss production, this is the highest quality component available in European market.



Rounded hole for lift tape
prevents damage of lift tape during whole lifetime of external blinds.

Components color matching
(ladder, lift tape, sealing profile in slats)

- » for light shades grey components are used
- » for dark shades black components are used

STANDARD SLAT COLORS

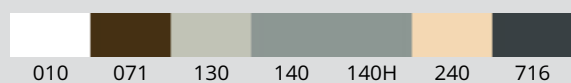

010 071 130 140 140H 240 716

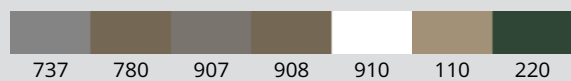

737 780 907 908 910 110 220



330 502 514 721 735 DB703 905

Standard colors on stock,
other colors upon request.

722

BASIC TECHNICAL PARAMETERS

control type	minimum width	maximum area
crank	400 mm	9 m ²
motor	600 mm	20 m ²
Max. width of blind		5000 mm
Max. height of blind		5000 mm
Max. width of connected blinds		8 m (motor-operated)

S-90 external blinds



S-90 EXTERNAL BLINDS

The S-90 external blinds are truly among the best. They are a perfect combination of functionality, effectiveness and graceful design.

They have excellent interior shading results, and with their rolled seal they, like the Z-shaped slats, also eliminate noise. In addition, they have an elegant, rounded S-shaped design. Their appearance is similar to that of roller blinds, which will be appreciated by those, who combine external blinds with roller blinds or roller doors on their house. If you are looking for a combination of elegant design and technological excellence, the S-90 blind is the right choice.

MAIN ADVANTAGES

- » **fully sealable design**
- » **best shading results**
- » **appearance similar to roller blinds – optional combination**
- » **noise-free operation and noise-eliminating seal**
- » **optional operation (crank handle/motor)**
- » **it's our strongest slat**



Metal ladder connection
made of stainless steel significantly increases lifetime of external blinds.



Upper profile
in two finishes (extruded aluminium or galvanized steel) is opened downwards:

- » allows free access to all components,
- » prevents sticking of dirt and other obstacles,
- » allows easy adjusting, eg. of gearbox.



Slat hooks
Slats are fixed to ladder by re-openable hooks, which allow easy exchange of any slat (repair on spot).



Elliptical metal pin
placed 1 piece on each slat alternating left or right reduces external noise and wind noise to minimum.

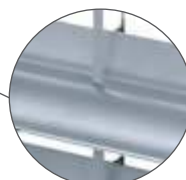

Quality lift tape
In our production we use lift tape 8 mm of Swiss production, this is the highest quality component available in European market.



Rounded hole for lift tape
prevents damage of lift tape during whole lifetime of external blinds.

Components color matching
(ladder, lift tape, sealing profile in slats)

- » for light shades grey components are used
- » for dark shades black components are used

STANDARD SLAT COLORS

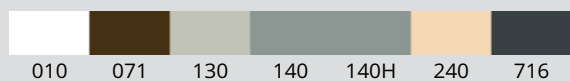

010 071 130 140 140H 240 716

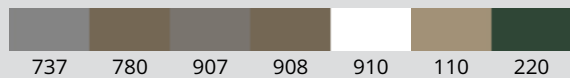

737 780 907 908 910 110 220

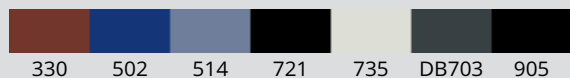

330 502 514 721 735 DB703 905

Standard colors on stock,
other colors upon request.

722

BASIC TECHNICAL PARAMETERS

control type	minimum width	maximum area
crank	400 mm	9 m ²
motor	600 mm	20 m ²
Max. width of blind		5000 mm
Max. height of blind		5000 mm
Max. width of connected blinds		8 m (motor-operated)

C-80 external blinds



C-80 EXTERNAL BLINDS

C-80 external blinds have a classical, curved C-shape with reinforced edges on both sides.

They can shade out high percentage of sunlight, thus preventing interior overheating. The seal in the guiding rails allows them to run silently. The variants with the guiding rails are more resistant to strong winds and therefore less noisy than blinds guided on a string.

MAIN ADVANTAGES

- » **very good shading results**
- » **very quiet operation**
- » **optional tilting on both sides**
- » **more resistant to wind thanks to reinforced edges**
- » **optional operation (crank handle/motor)**
- » **slat guide options (string/guiding rail) available**

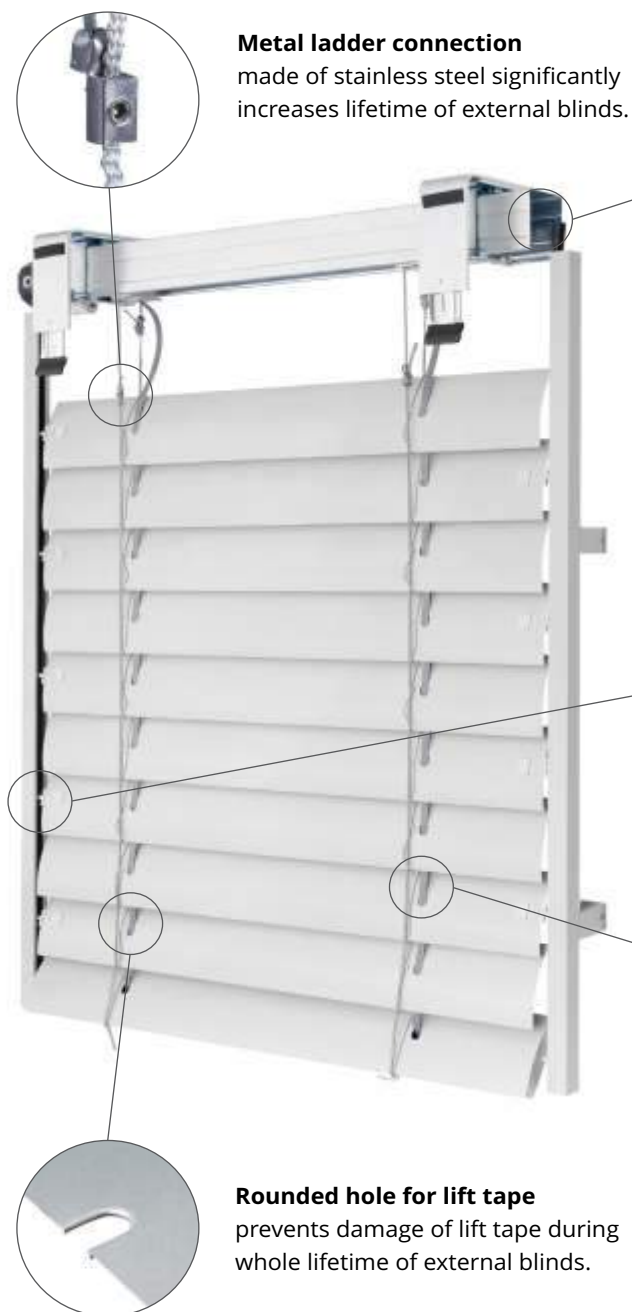

Metal ladder connection
made of stainless steel significantly increases lifetime of external blinds.



Upper profile
in two finishes (extruded aluminium or galvanized steel) is opened downwards:

- » allows free access to all components,
- » prevents sticking of dirt and other obstacles,
- » allows easy adjusting, eg. of gearbox.



Plastic guiding pin
Made of a solid, resistant material, not riveted to the slat so it could be therefore easily replaced.



Quality lift tape
In our production we use lift tape 8 mm of swiss production, this is the highest quality component available in European market.



Rounded hole for lift tape
prevents damage of lift tape during whole lifetime of external blinds.

Components color matching
(ladder, lift tape, guiding pins)

- » for light shades grey components are used
- » for dark shades black components are used

STANDARD SLAT COLORS

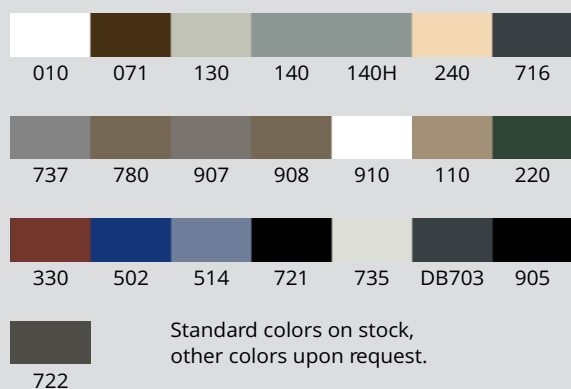

BASIC TECHNICAL PARAMETERS

control type	minimum width	maximum area
crank	400 mm	9 m ²
motor	600 mm	20 m ²
Max. width of blind		5000 mm
Max. height of blind		5000 mm
Max. width of connected blinds		8 m (motor-operated)

Z-70 external blinds

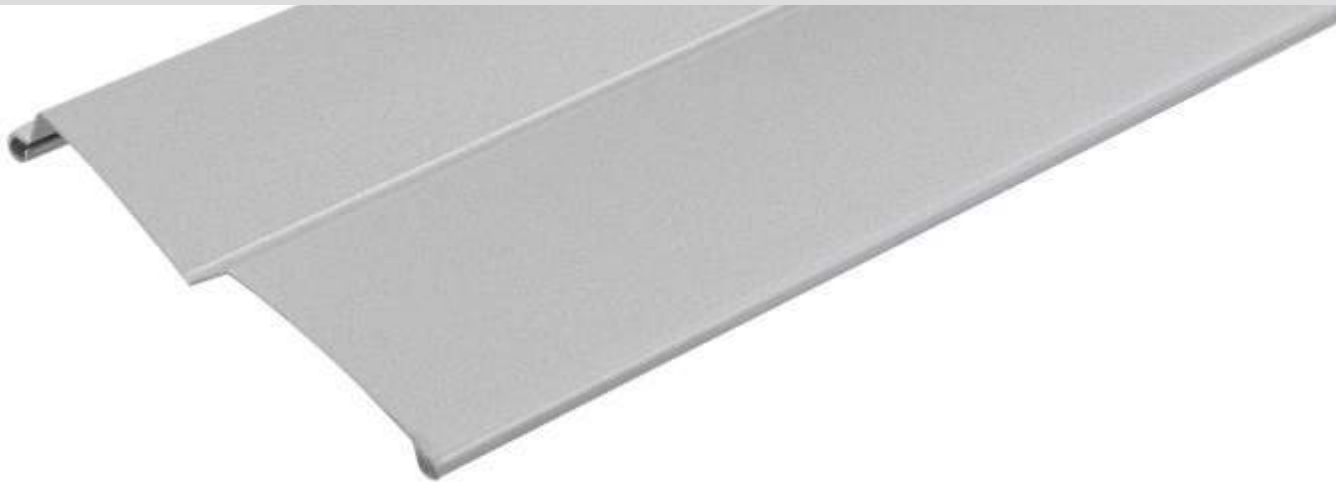

Z-70 EXTERNAL BLINDS

Z-type external blinds are technically the best types of external blinds available.

Z-70 external blinds have a very modern Z-shape, allowing for complete closing of slats. They are functional and effective, and their functionalistic, angular shape fits very well into modern exteriors. These blinds have excellent interior shading results, and with their rolled seal they also efficiently eliminate noise. Technological excellence combined with angular, minimalist design – that is the Z-70 blind.

MAIN ADVANTAGES

- » fully sealable design
- » best shading results
- » noise-free operation and noise-eliminating seal
- » very strong slats
- » optional operation (crank handle/motor)
- » it's suitable for places with narrow dado thanks to its narrow slats

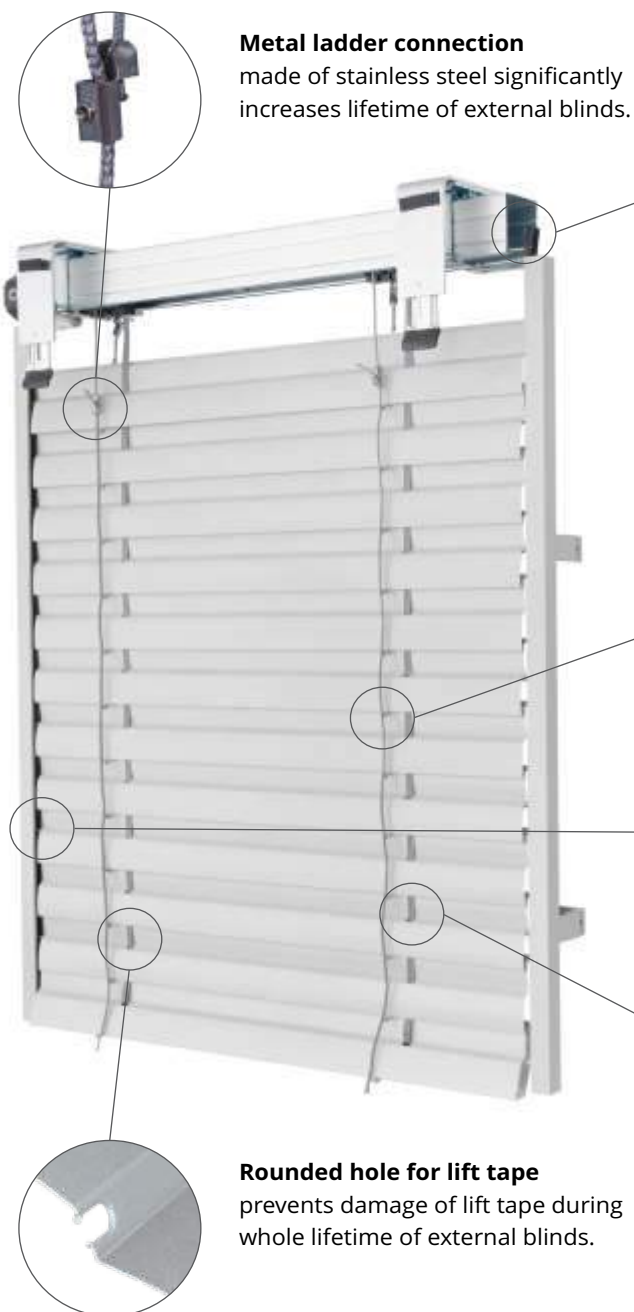

Metal ladder connection
made of stainless steel significantly increases lifetime of external blinds.



Upper profile
in two finishes (extruded aluminium or galvanized steel) is opened downwards:
» allows free access to all components,
» prevents sticking of dirt and other obstacles,
» allows easy adjusting, eg. of gearbox.



Slat hooks
Slats are fixed to ladder by re-openable hooks, which allow easy exchange of any slat (repair on spot).



Elliptical metal pin
placed 1 piece on each slat alternating left or right reduces external noise and wind noise to minimum.



Quality lift tape
In our production we use lift tape 8 mm of Swiss production, this is the highest quality component available in European market.



Rounded hole for lift tape
prevents damage of lift tape during whole lifetime of external blinds.

Components color matching
(ladder, lift tape, sealing profile in slats)
» for light shades grey components are used
» for dark shades black components are used

STANDARD SLAT COLORS

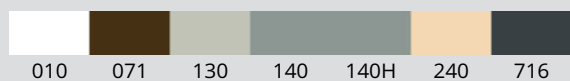

010 071 130 140 140H 240 716

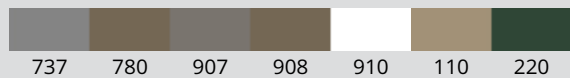

737 780 907 908 910 110 220

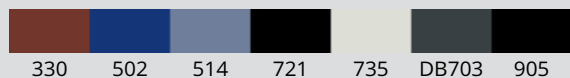

330 502 514 721 735 DB703 905

Standard colors on stock,
other colors upon request.

722

BASIC TECHNICAL PARAMETERS

control type	minimum width	maximum area
crank	400 mm	9 m ²
motor	600 mm	20 m ²
Max. width of blind		5000 mm
Max. height of blind		5000 mm
Max. width of connected blinds		8 m (motor-operated)

C-65 external blinds

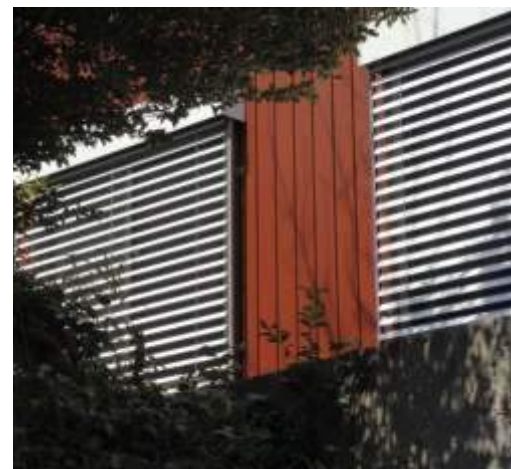

C-65 EXTERNAL BLINDS

C-65 external blinds have a classical, curved C-shape with reinforced edges on both sides.

They can shade out high percentage of sunlight, thus preventing interior overheating. The seal in the guide rails allows them to run silently. The variants with a track in the guide rails are more resistant to strong winds and therefore less noisy than blinds on a string.

MAIN ADVANTAGES

- » very good shading results
- » very quiet operation
- » optional tilting on both sides
- » more resistant to wind thanks to reinforced edges
- » optional operation (crank handle/motor)
- » slat guide options (string/guiding rail) available
- » it's suitable for places with narrow dado thanks to its narrow slats



Metal ladder connection
made of stainless steel significantly increases lifetime of external blinds.



Upper profile
in two finishes (extruded aluminium or galvanized steel) is opened downwards:
 » allows free access to all components,
 » prevents sticking of dirt and other obstacles,
 » allows easy adjusting, eg. of gearbox.



Plastic guiding pin
Made of a solid, resistant material, not riveted to the slat so it could be therefore easily replaced.

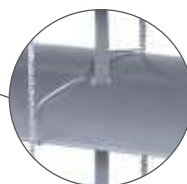

Quality lift tape
In our production we use lift tape 8 mm of Swiss production, this is the highest quality component available in European market.



Rounded hole for lift tape
prevents damage of lift tape during whole lifetime of external blinds.

Components color matching
(ladder, lift tape, guiding pins)
 » for light shades grey components are used
 » for dark shades black components are used

STANDARD SLAT COLORS



Standard colors on stock, other colors upon request.

BASIC TECHNICAL PARAMETERS

control type	minimum width	maximum area
crank	400 mm	9 m ²
motor	600 mm	20 m ²
Max. width of blind		5000 mm
Max. height of blind		5000 mm
Max. width of connected blinds		8 m (motor-operated)

E-50 external blinds



E-50 EXTERNAL BLINDS

E-50 external blinds have a classical, curved C-shape without reinforced edges.

The slats with their flat shape form a thin stack after being raised and do not take up much room. They have good shading results. Type E-50M is made for standard control by means of a crank handle or motor located in the 56 x 58 mm upper profile. Type E-50K is made for standard control by means of an endless cord or crank located in the 40 x 40 mm upper profile.

MAIN ADVANTAGES

- » **good shading results**
- » **thin packet of slats after raising the blind**
- » **optional tilting on both sides**
- » **optional operation (crank handle/motor)**
- » **slat guide options (with or without string) available**



Metal ladder connection (E-50M)
made of stainless steel significantly increases lifetime of external blinds.



Upper profile

for type E-50M in two finishes (extruded aluminium or galvanized steel) and for E-50K in extruded aluminium is opened downwards:

- » allows free access to all components,
- » prevents sticking of dirt and other obstacles,
- » allows easy adjusting, eg. of gearbox.



Guiding stainless steel string

PVC cover of wire increases lifetime and resistance of external blind.



Quality lift tape

In our production we use lift tape 6 mm of Swiss production, this is the highest quality component available in European market.

STANDARD SLAT COLORS

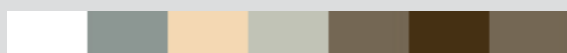

5010 5140 5240 5130 5908 5071 5780



5365

Standard colors on stock, other colors upon request.

BASIC TECHNICAL PARAMETERS

control type	minimum width	maximum area
cord	400 mm	5 m ²
crank	400 mm	8 m ² (E-50K) 9 m ² (E-50M)
motor	600 mm	14 m ²
Max. width of blind		3500 mm
Max. height of blind		3000 mm (E-50K) 4000 mm (E-50M)



Common information for self-bearing STF systems

Position of the cover sheet in relation to the STF profile

Cover sheets with D bending (F31, F32)

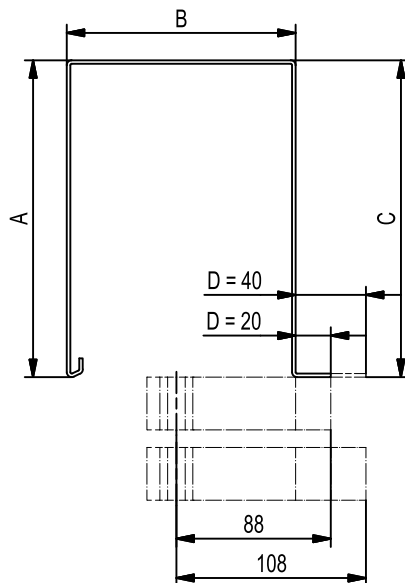

Cover sheets without D bending (F11, F21, F30, F33)

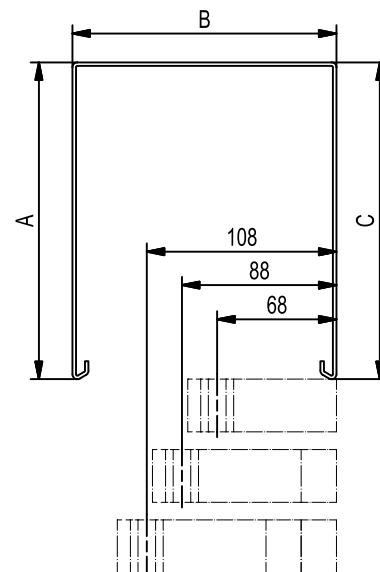

STF system with the F31 and F32 cover sheets has to be always ordered with one, alternatively two, extending profiles (according to the dimension D - 20/40 mm).

Position of ISO-KASTL case in relation to STF profile

ISO-KASTL case without insulation

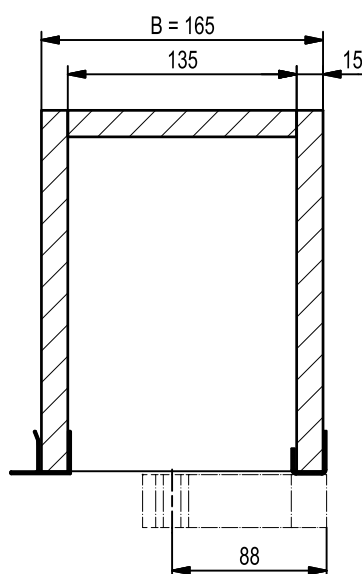

ISO-KASTL case with insulation

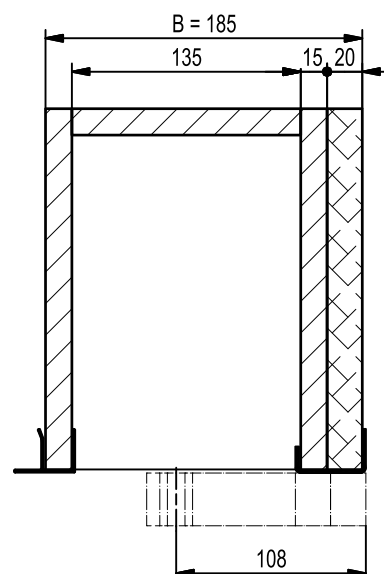

STF system with ISO-KASTL case without insulation and with the back lath type U has to be always ordered with one extending profile.

STF system with ISO-KASTL case with insulation and with the back lath type U has to be always ordered with two extending profiles.



Types of cover sheets

Types of covers for external blinds

Type 1

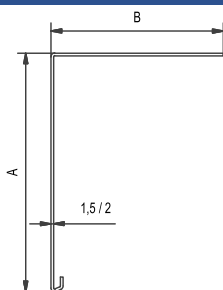

Type 1B

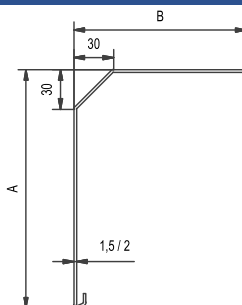

Type 1C

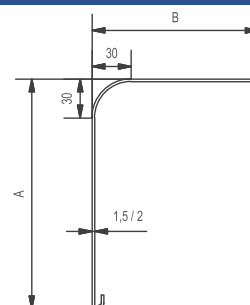

Type 1CH12

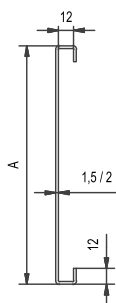

Type 1CH14

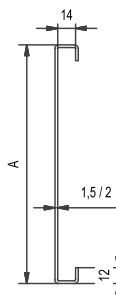

Type 1H

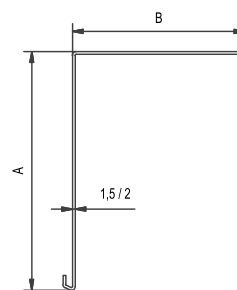

Type Z

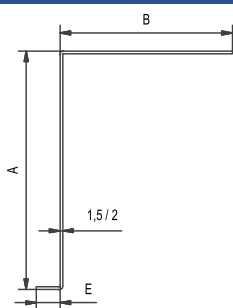

Type 1L

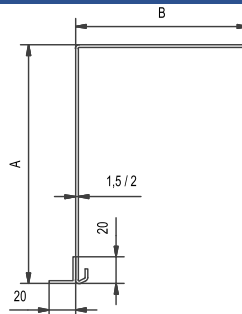

Type 11

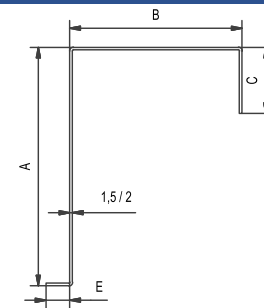

Type 2

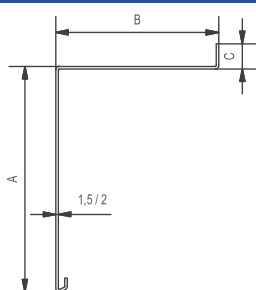

Type 2B

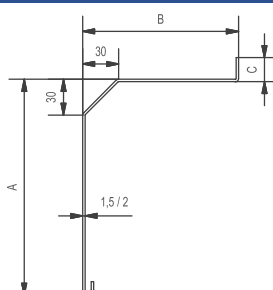

Type 2C

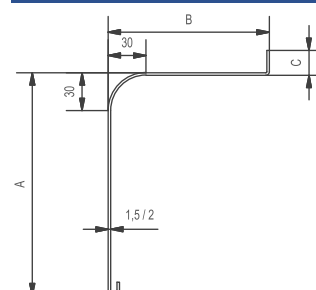



Types of cover sheets

Type 21

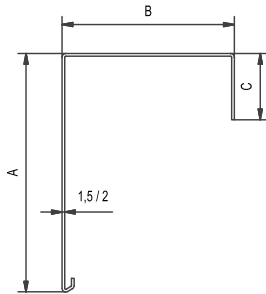

Type 3

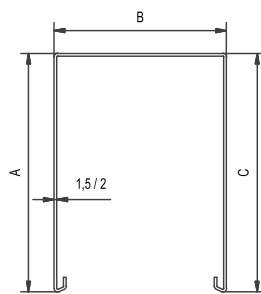

Type 31

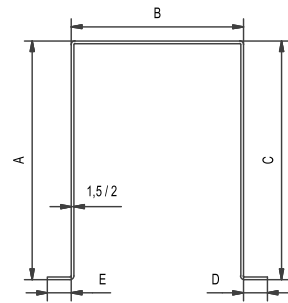

Type 32

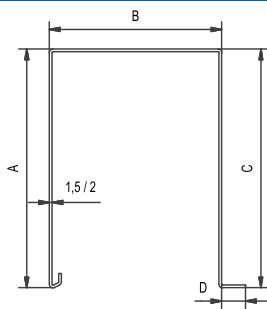

Type 33

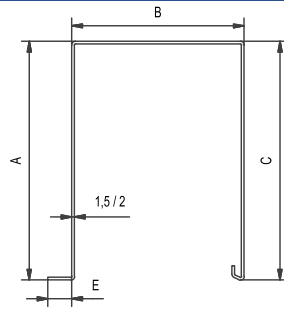

Bending detail

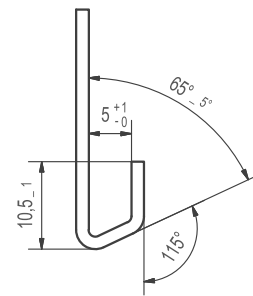

Standard varnishing of the cover sheets

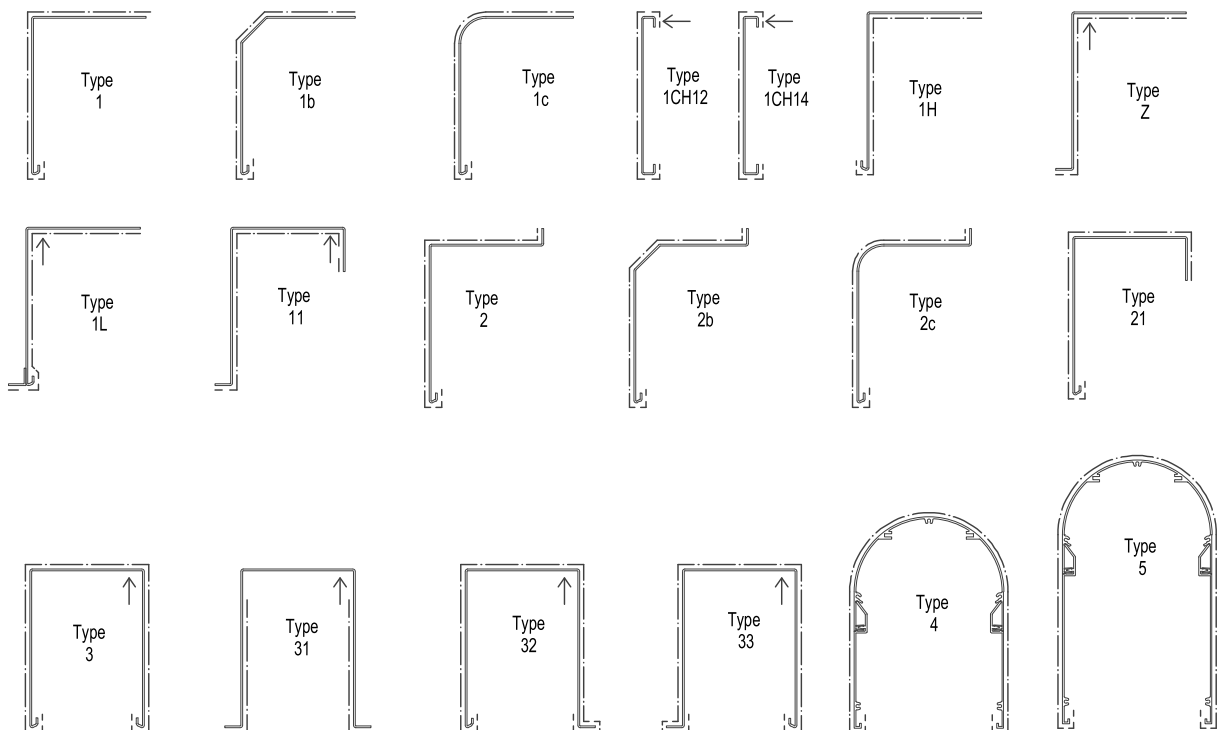

Note: - - - - - standard range of varnishing

↑ holes necessary for suspending when varnishing



Types of guiding rail holders

Holder standard

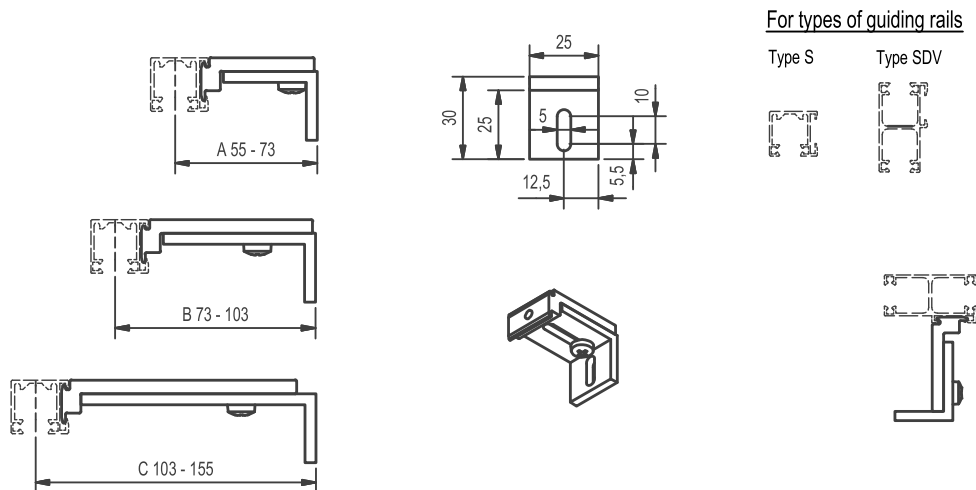

Holder telescopic

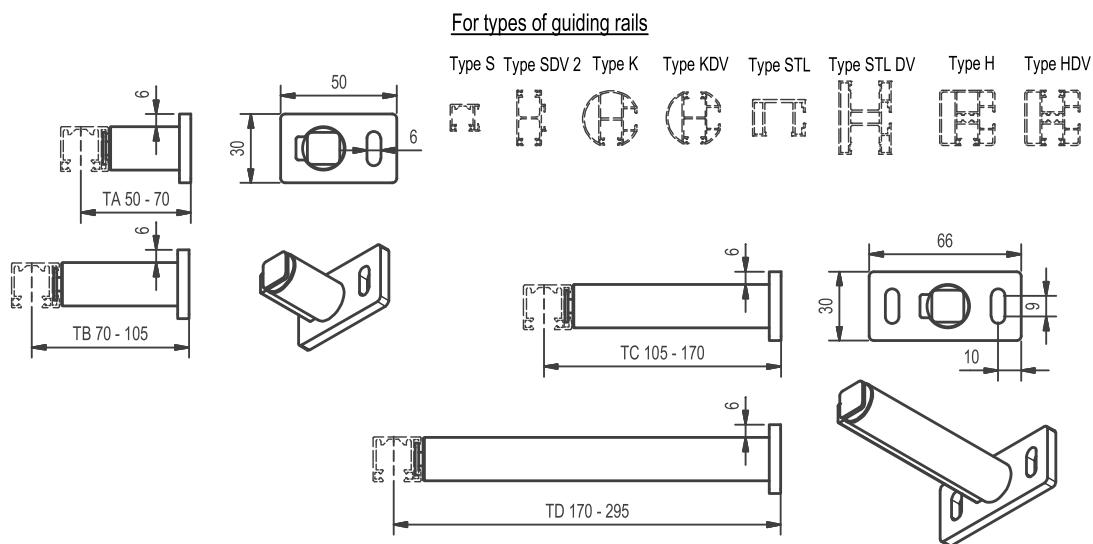

*Attention: The telescopic holder base exceeds the blind width by 6 mm on each side. They can carry only the weight of guiding rails (never the weight of the whole blind).

Holder KV

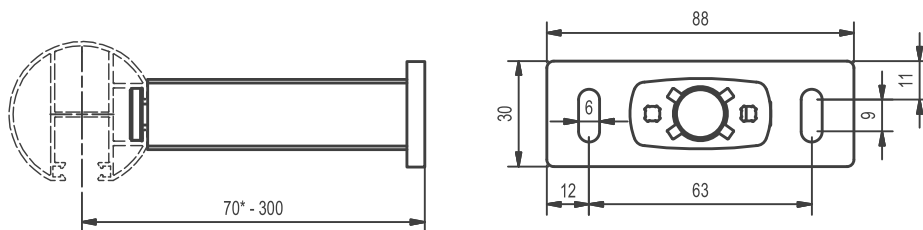

* For facade blinds minimal 85 mm.

For types of guiding rails

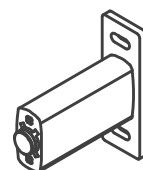
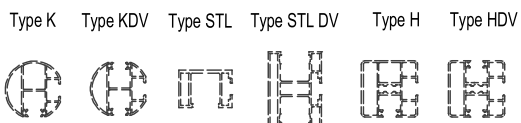



Technical info

9.2. Taking dimension measurements for blinds

Taking measurements for standard blinds - guiding rails

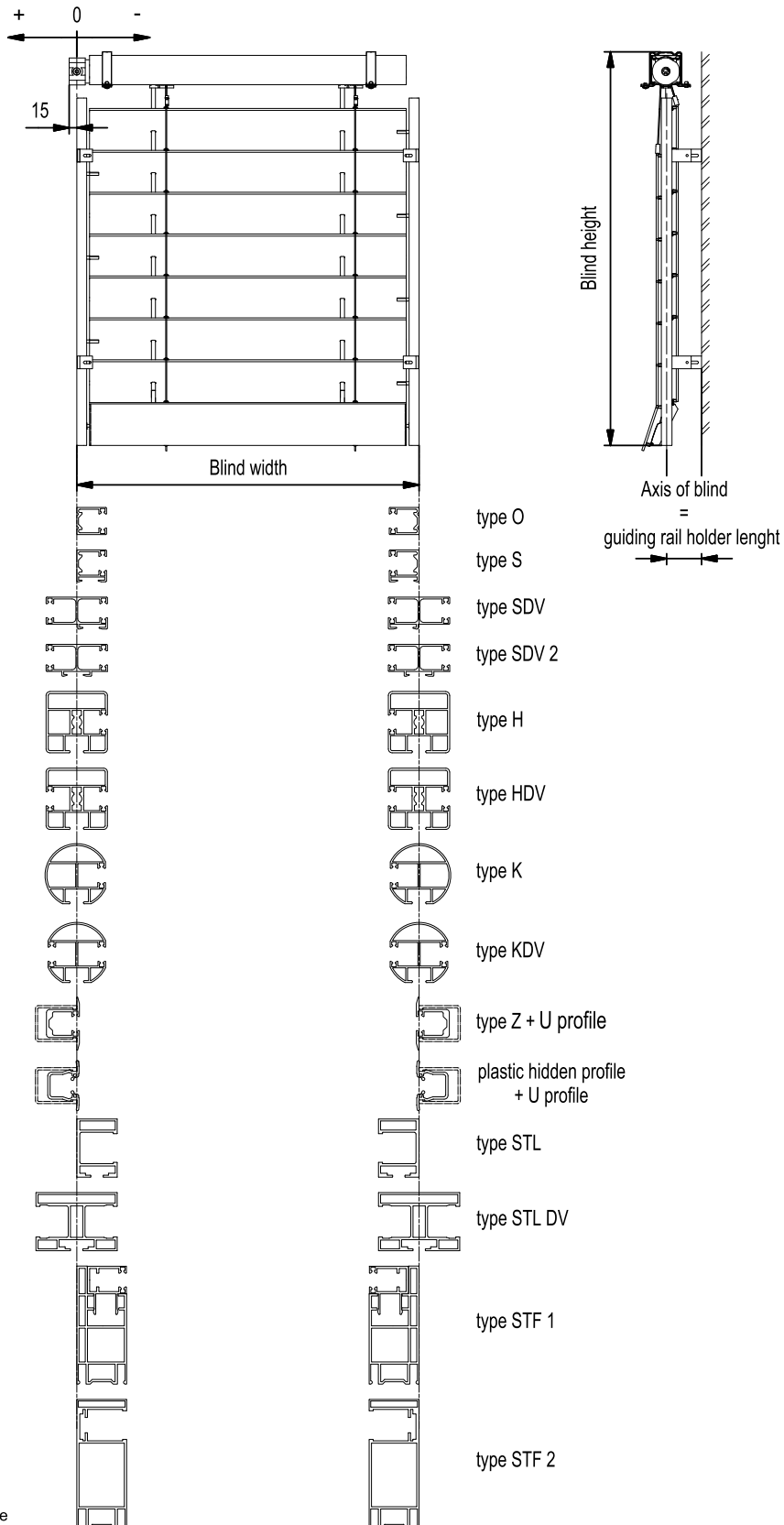

Note: view from the inside



9.12. Blind packet height

Overall blind height in mm	Blind packet height in mm							
	S-90 Z-90	Z-70	C-80	C-65	F-80 string	F-80 guiding rail	E-50M	E-50K
500-1250	180*	200	190*	200	150*	160*	140	110
1251-1500	190*	220	210	220	160*	170*	153	125
1501-1750	200*	230	230	240	170*	180*	165	135
1751-2000	210*	250	240	260	170*	190	173	143
2001-2250	220*	270	250	280	180*	200	183	153
2251-2500	240	280	270	300	190	210	195	165
2501-2750	250	300	280	320	200	220	205	175
2751-3000	260	320	300	340	200	230	215	185
3001-3250	280	340	320	360	210	240	225	
3251-3500	290	350	330	380	220	250	240	
3501-3750	300	370	350	400	220	260	250	
3751-4000	310	390	360	420	230	260	265	
4001-4250	330	410	380	440				
4251-4500	340	420	400	460				
4501-4750	350	440	410	480				
4751-5000	360	460	430	500				

The above dimensions are only indicative.

*Consider the height of the cover sheet. With lowered blind, in open position, at maximum height V there may be a gap between the cover sheet and the 1st slat (see Fig. 1). For identified items we recommend a minimum height of the cover sheet to be 230 mm for Z-90 and S-90, 200 mm for C-80 and 190 mm for F-80, or order blinds with height V at zero (see Fig.2).



Stavrochori, Kilkis, 61100, Greece
t: +30 23410 71480
f: +30 23410 75785
info@aluminrolls.gr
www.aluminrolls.gr